

## STEPS for using mSBM Offline Photo Android App

(Last Updated on: 27 July 2016)

### How to install the app

- a) Please go to <http://msbmurban.gov.in> and click **SBM Offline Geo Tag App for Android** button on downloads. If you have downloaded the APK on computer, and then you need to transfer it to your Smartphone using USB cable. Once you have the APK on your mobile, you need to install it.
- b) Make sure that the first selection, Unknown Sources, is checked (On some phones, this might be under Settings->Security). This is to allow you to download an application that is not part of the Android market.
- c) Once the installation is done, you can use the application.
- d) If your phone **version Android 6.0(Marshmallow)**, please read **FAQ** (<http://msbmurban.gov.in>).

### Starting the application

To start the **SBM Offline Photo** application, follow the steps given below:

- a) Click on **SBM Offline Photo** icon  in application menu.
- b) Please activate **GPS** in your phone.

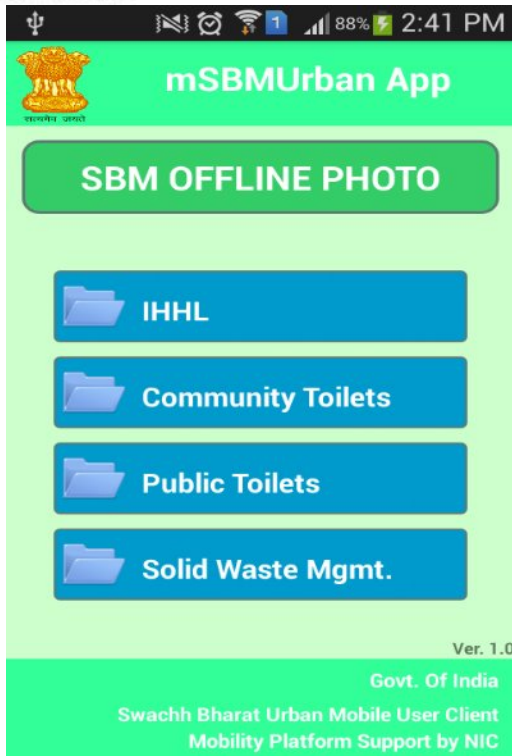

- 1) Click on respective folders for uploading the photo.
- 2) If you not activate **GPS** than please enable it.

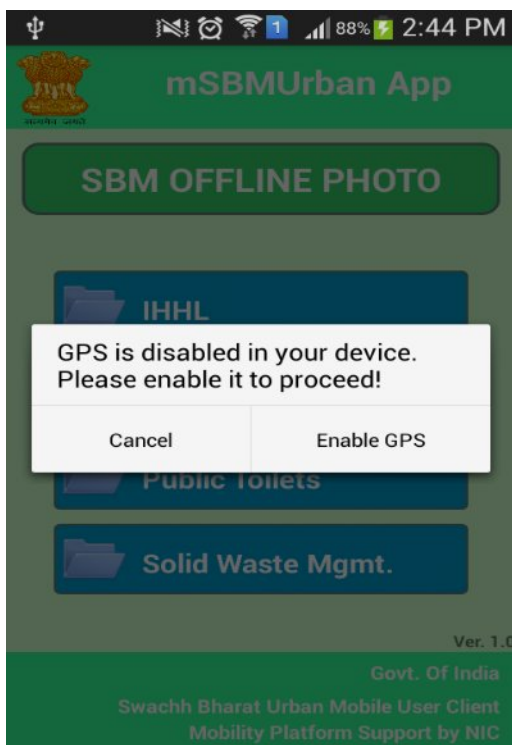

3) For IHHL enter Application ID.

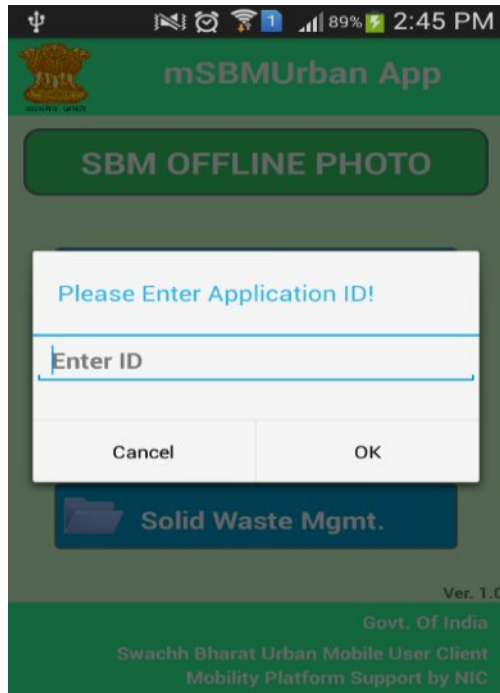

4) For Community/ Public toilets, enter Toilet ID.

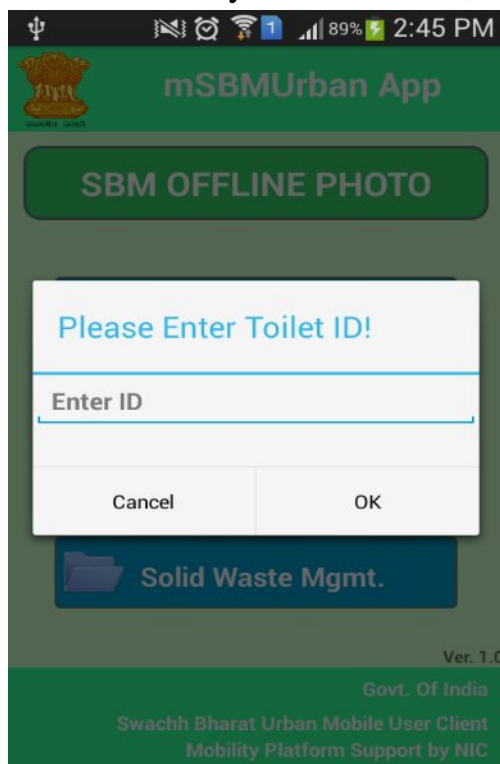

5) For Solid Waste Mgmt. enter SWM Component ID.

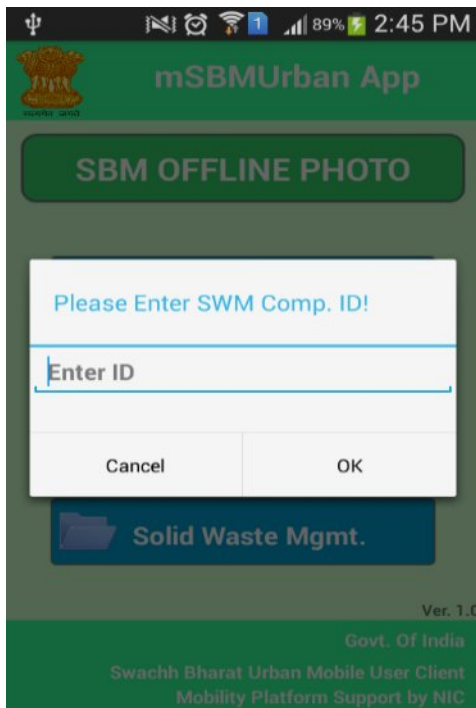

6) For example, in case of IHHL enter Application ID for toilet. The captured photo would be stored in **SBM Photo** folder and subsequently used in **mSBM Urban Geo Tagged App**, where you can select this captured photo from (**Choose from gallery**) option.

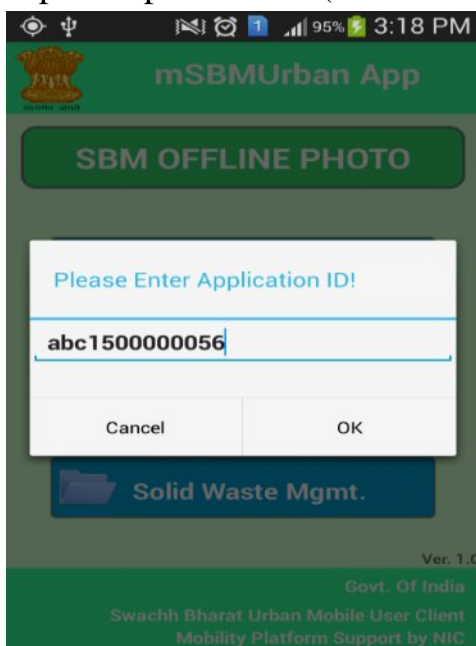

- 7) After pressing OK button, user can click on Take Image button to capture photo.

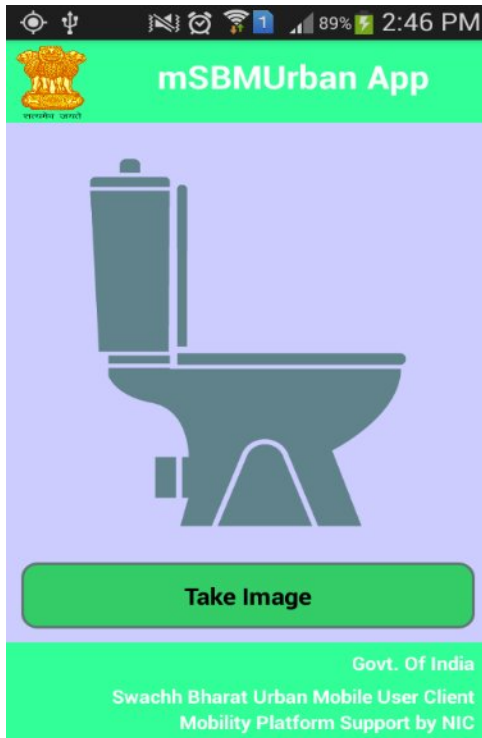

- 8) Click on **Take Image** button to capture photo.

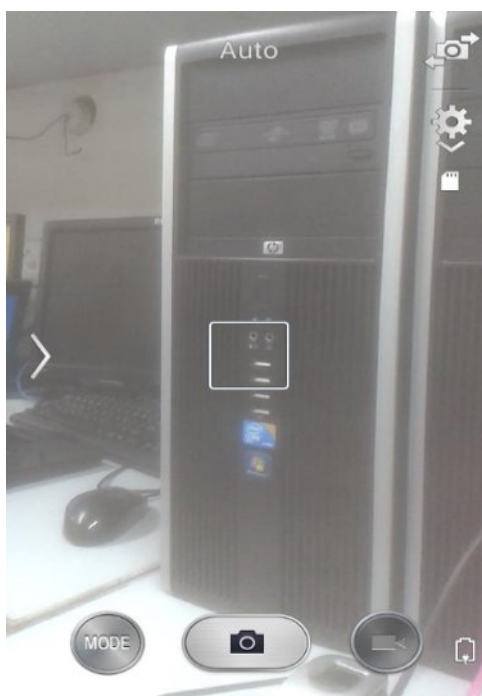

9) Click on save button to save the photo.



10) Captured photo should show Latitude and Longitude values.



- 11) If your Latitude and Longitude show zero on capture photo than check GPS (It may not be stable) and go back on home and again enter id and capture photo.



- 12) If you want to check photo than go to SD Card.

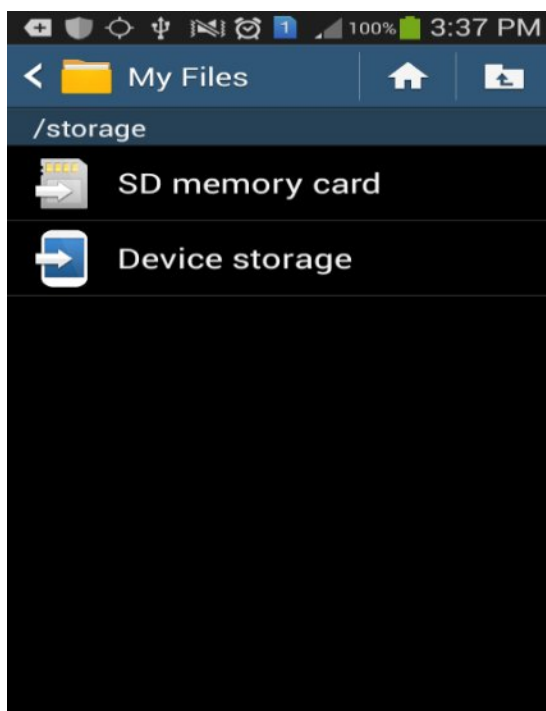



13) Click on Device storage and find SBM Photo folder.

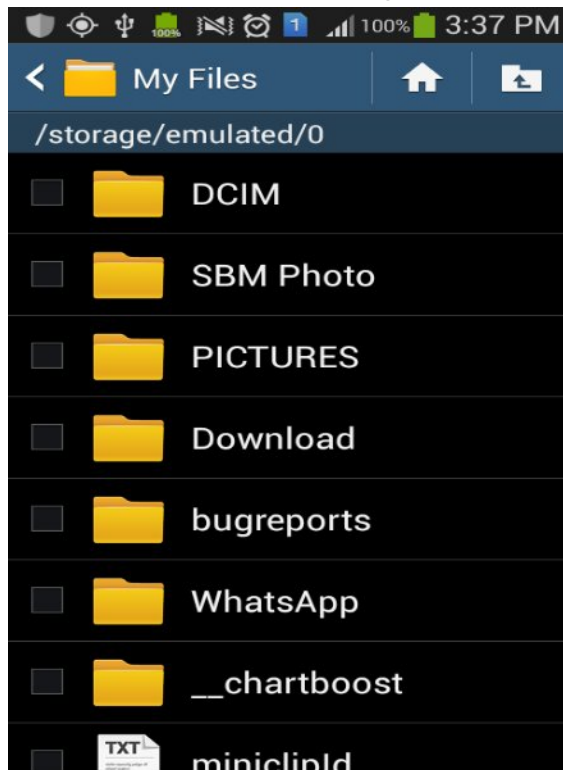

14) Click on SBM Photo folder and find photo.

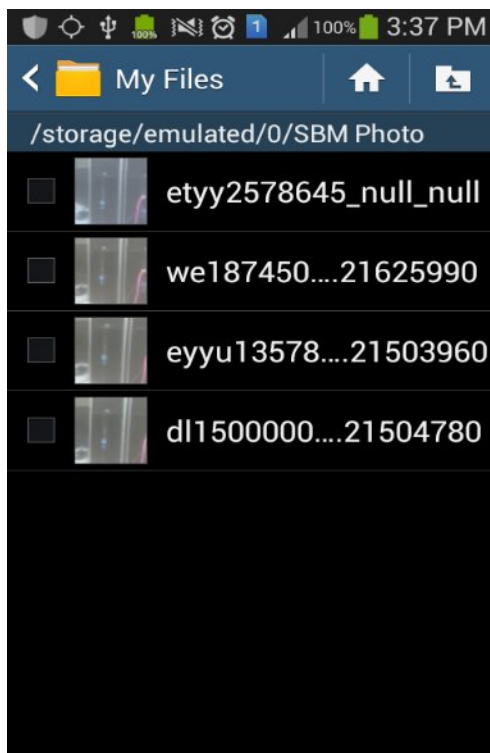

15) Thank You.....